

LOT 18

LOT 19

S 06°-42' W 50.00'

FILED
GREENVILLE CO. S.C.

MAR 31 3 14 PM '86

JENNIE S. FANKERSLEY



LOT 11

S 83°-25' E 228.34'

PT. LOT 10

S 83°-25' E 228.24'

PT. LOT 10

This is to certify that on March 26, 1986, I surveyed the property shown on this plat, known as Part Lot 10 on plat of Piedmont Park, recorded in the R.M.C. Office of Greenville County, in Plat Book F at Page 290, and that the property lines, walls and buildings are as shown hereon, that the building located on said lot does not encroach or project on adjacent streets or property, and that no adjacent walls or buildings encroach or project on said premises, and that no utility R/W's cross this property except as shown hereon. According to the Flood Rate Insurance Map and to the best of my knowledge, this structure is not in an Established Flood Zone.

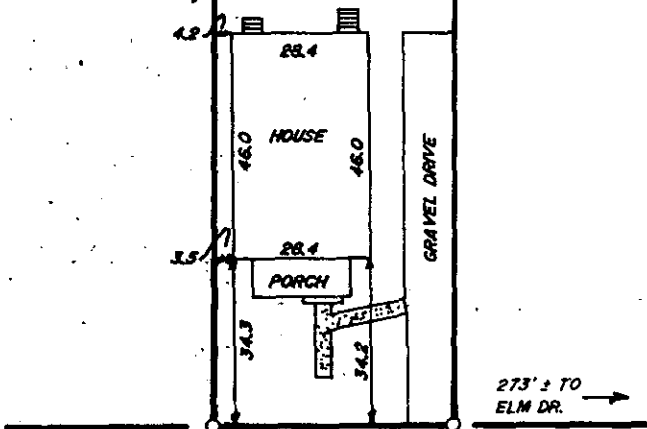

N 06°-35' E 50.00'

MAPLECROFT ST.

Frederick E. Landrith

Frederick E. Landrith, RLS 7954

MAR 31 1986

22-N-94
31916

THIS PROPERTY IS SUBJECT TO ANY AND ALL RIGHTS OF WAY AND EASEMENTS OF RECORD.

LANDRITH SURVEYING

Land Surveys - Topographical Maps
Construction Layout

628-C WADE HAMPTON BLVD.
GREENVILLE, S.C. 29609
(803) 271-8336

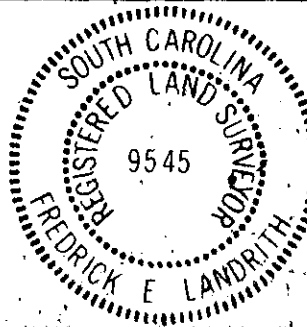

**STATE of SOUTH CAROLINA
COUNTY of GREENVILLE**

PIEDMONT PARK

PT. LOT 10
PROPERTY OF

**ELLIS E. ESHELMAN
MARILYN K. ESHELMAN**

SURVEYED BY *WES*

CHK'D BY *FEL*

DRAWN BY *JMW*

DATE **MAR 27, 1986**

SEAL

PROJECT NO. **06-443 31801**